

Marie Curie

Introduction to 3D Modelling
Coursework Presentation

WORK SPACE

LABORATORY

Lack of cameras during this time period?

No “real” demand for pictures?

No pictures allowed?

Nothing visually important to capture?

FINDING IMAGES IS HARD

Nevertheless, old grainy historical photos...

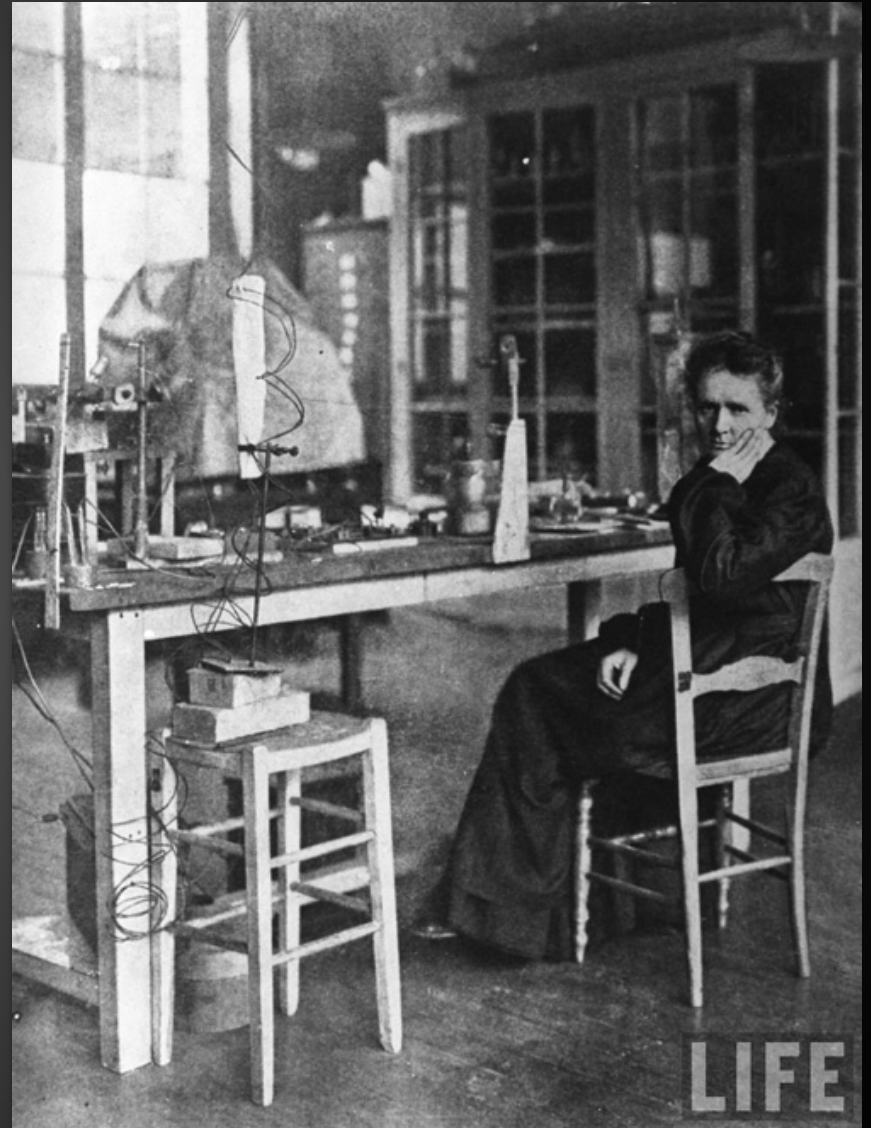
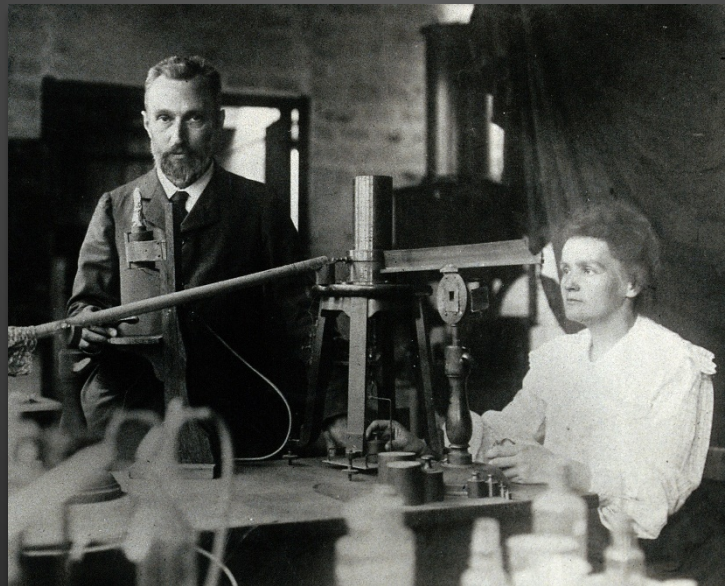

Modern images from Musée Curie...



Modern images from Musée Curie...



Modern images from Musée Curie...



Modern images from Musée Curie...



OLD

OR

NEW



WORK SPACE

POTENTIAL OBJECTS TO MODEL

- Chair
- Stool
- Cabinet
- Old wooden desk
- Aerial (...thing!)
- Scattered equipment and tools on the desk

Although it is a good image with a comfortable range of objects to model, the room is far too spacious.

However, these objects can be used alongside the other reference images.



- Appropriately sized room.
- Scattered work tables and spaces; the room does not feel too open.
- Minor details such as pipes, cabling and taps on walls.
- Various glass objects – particularly in the cabinet.
- Wooden cabinets with tiled surfaces.
- Stool(s) and chair.



- Rounded sink in the middle of the room.
- Panel of switches on the wall.
- Shelf or stand on workspace with more glass objects.
- Wooden and glass box with slide front.
- More storage compartments below desk.
- Various pieces of equipment and vials.
- Too many doors.

WORK SPACE

LABORATORY CONSTRUCTION

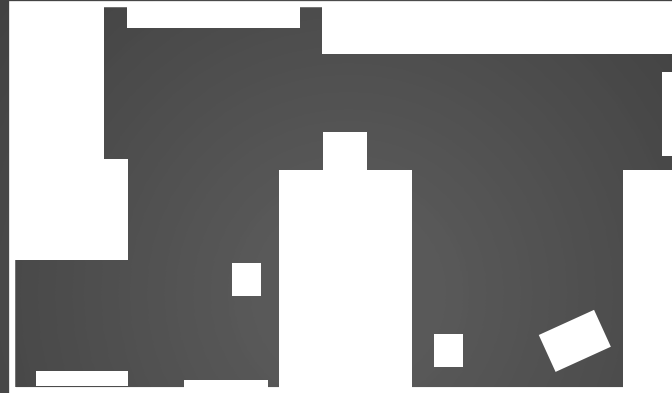

Room shall be designed with respect to Musée Curie images

BUT

Have a decayed appearance.



Features of such environments include:

- Dust scattered on objects
- Broken windows and panes
- Damaged fragile objects
- Excess grime and dirt
- Dirty loose tiles and missing tiles
- Miscellaneous debris on floor and surfaces
- Worn fabrics and materials
- Potentially untidy placement of objects

MAIN OBJECTS TO MODEL:

- Corner Desk
- Cabinets
- Side Workspace
 - With the wooden and glass slide box?
- Window
- Sink
- Chair
- Stool
- Switch Panel
- Door

The grid and blackout is just for a rough guide.

The biggest object (corner desk) should be sized first and have other objects be sized with respect to it.

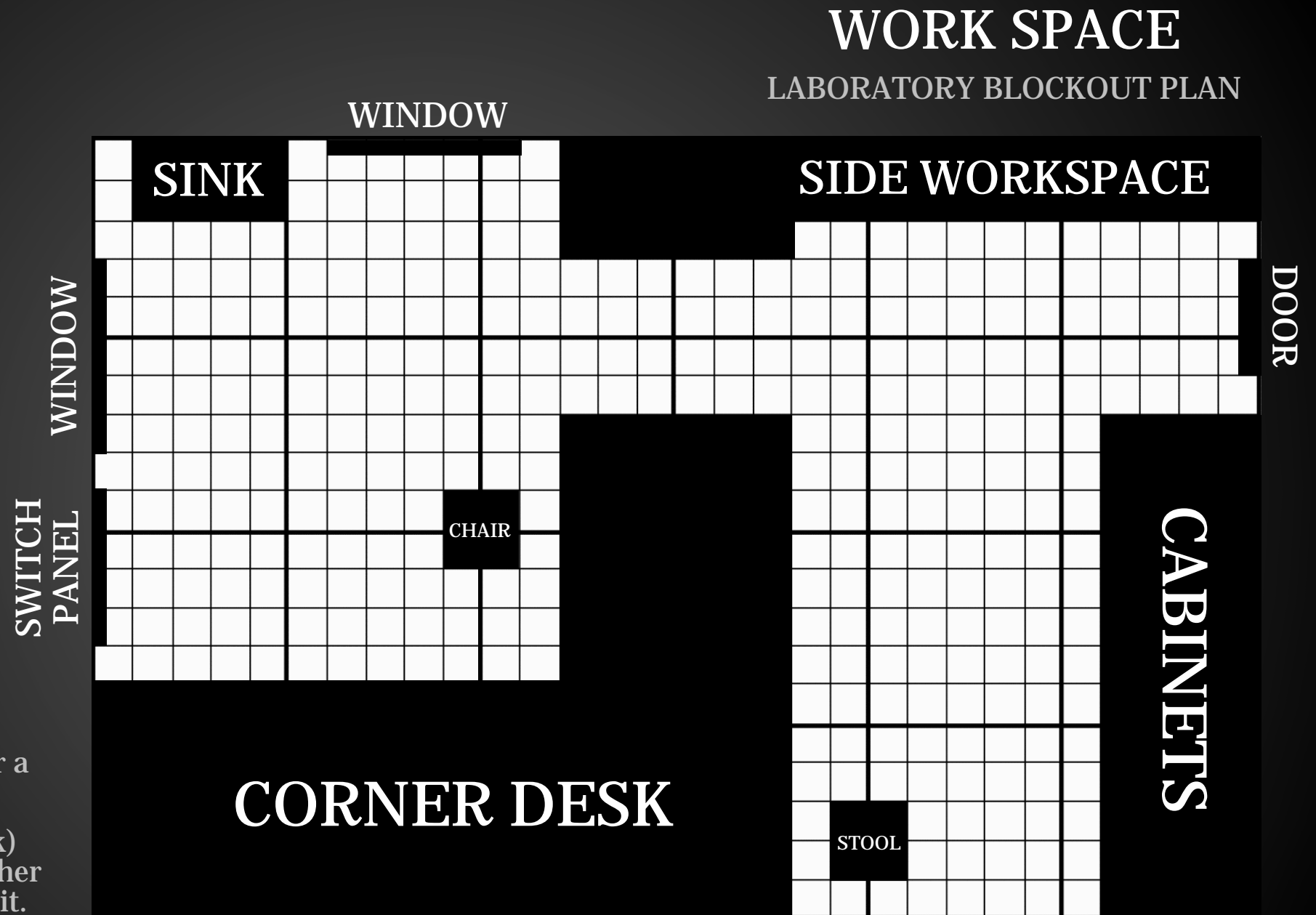

WORK SPACE

SKETCHES AND BREAKDOWN

CORNER DESK

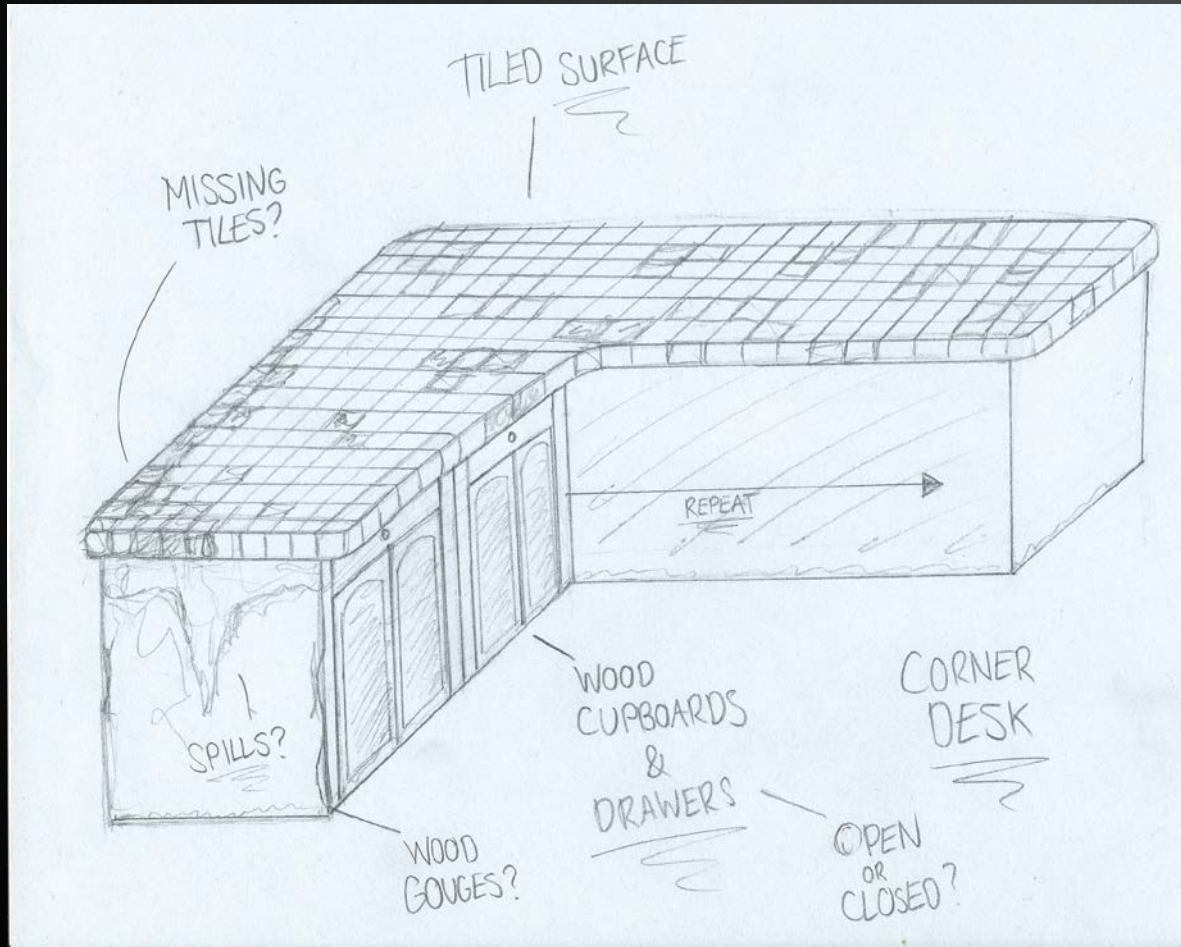

CABINET

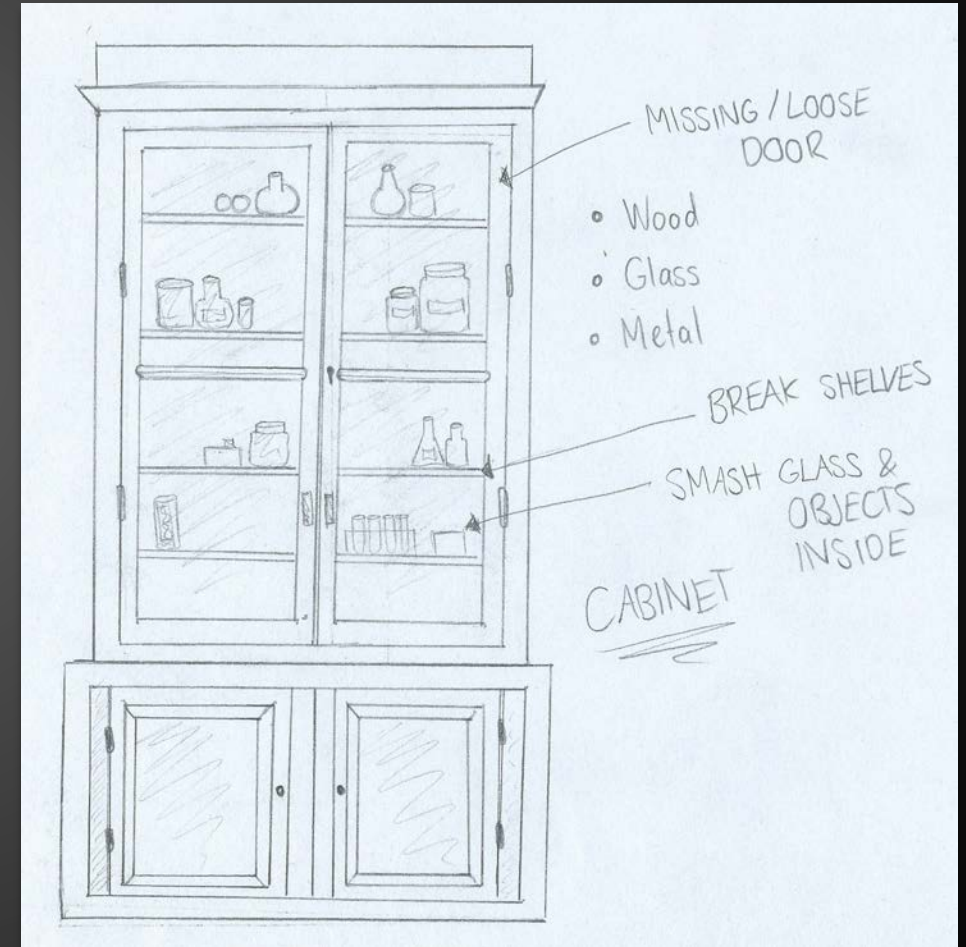

WORK SPACE

SKETCHES AND BREAKDOWN

CHAIR

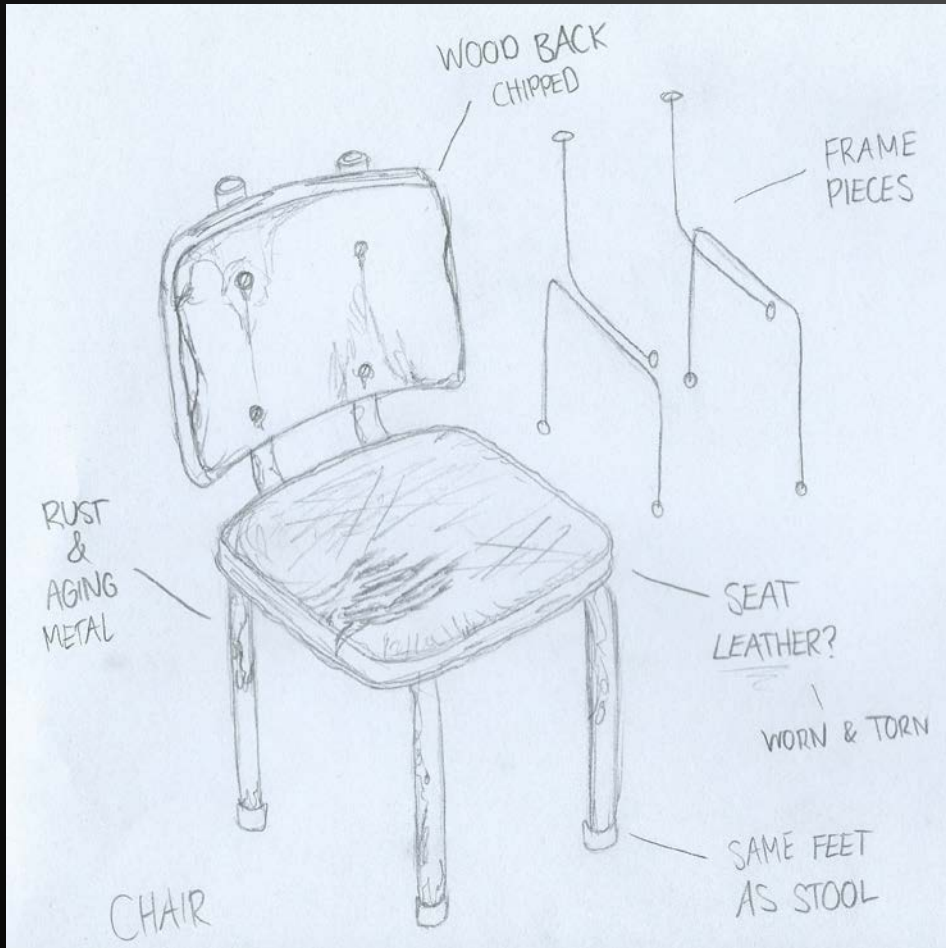

STOOL

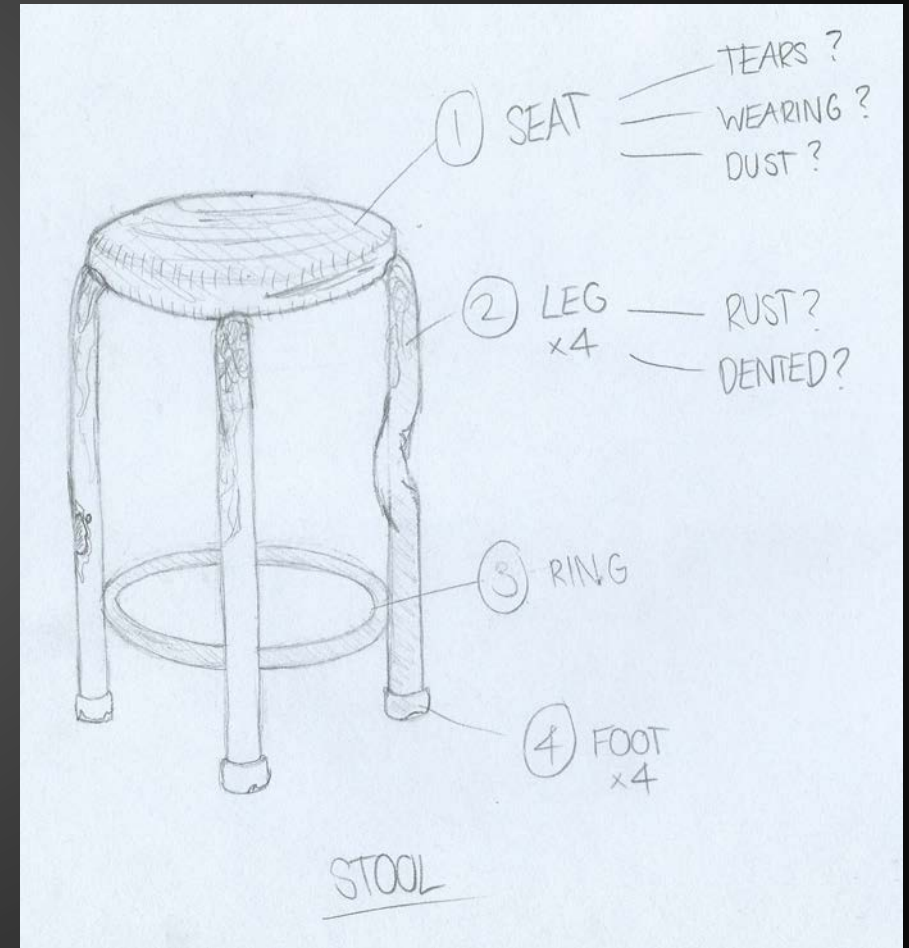

WORK SPACE

REFERENCE IMAGES

SWITCH PANEL



WORK SPACE

REFERENCE IMAGES

WINDOW & DOOR



LIVING SPACE

BEDROOM



The living space room shall be derived and designed from the office exhibit in the Musée Curie – one of few good sources.



- The room can be based off these images.
- Various large objects to model with a good range of smaller detail objects.
- Some models from the laboratory can be reused in this room – for e.g, the cabinets are identical in both rooms.
- A bed needs to fit appropriately in the room. This requires a separate source.

LIVING SPACE

POTENTIAL OBJECTS TO MODEL

- Chair
- Cabinet (re-use?)
- Wooden desk
- Table Lamp
- Telephone
- Miscellaneous books



LIVING SPACE

POTENTIAL OBJECTS TO MODEL

- Chair
- Cabinet (re-use?)
- Wooden desk
- Table Lamp
- Telephone
- Miscellaneous books
- Display cabinet
- Drawers
- Photo frame
- Ornaments



BED

REFERENCE IMAGES

In order for it to fit with the room, images and designs for beds were checked against Marie Curie's time period.



BED

REFERENCE IMAGES

In order for it to fit with the room, images and designs for beds were checked against Marie Curie's time period.



© Niki Fejjen

MAIN OBJECTS TO MODEL:

- Bed
- Cabinets
- Desk
- Table Lamp
- Drawers
- Display Cabinet
- Window
- Door
- Chair

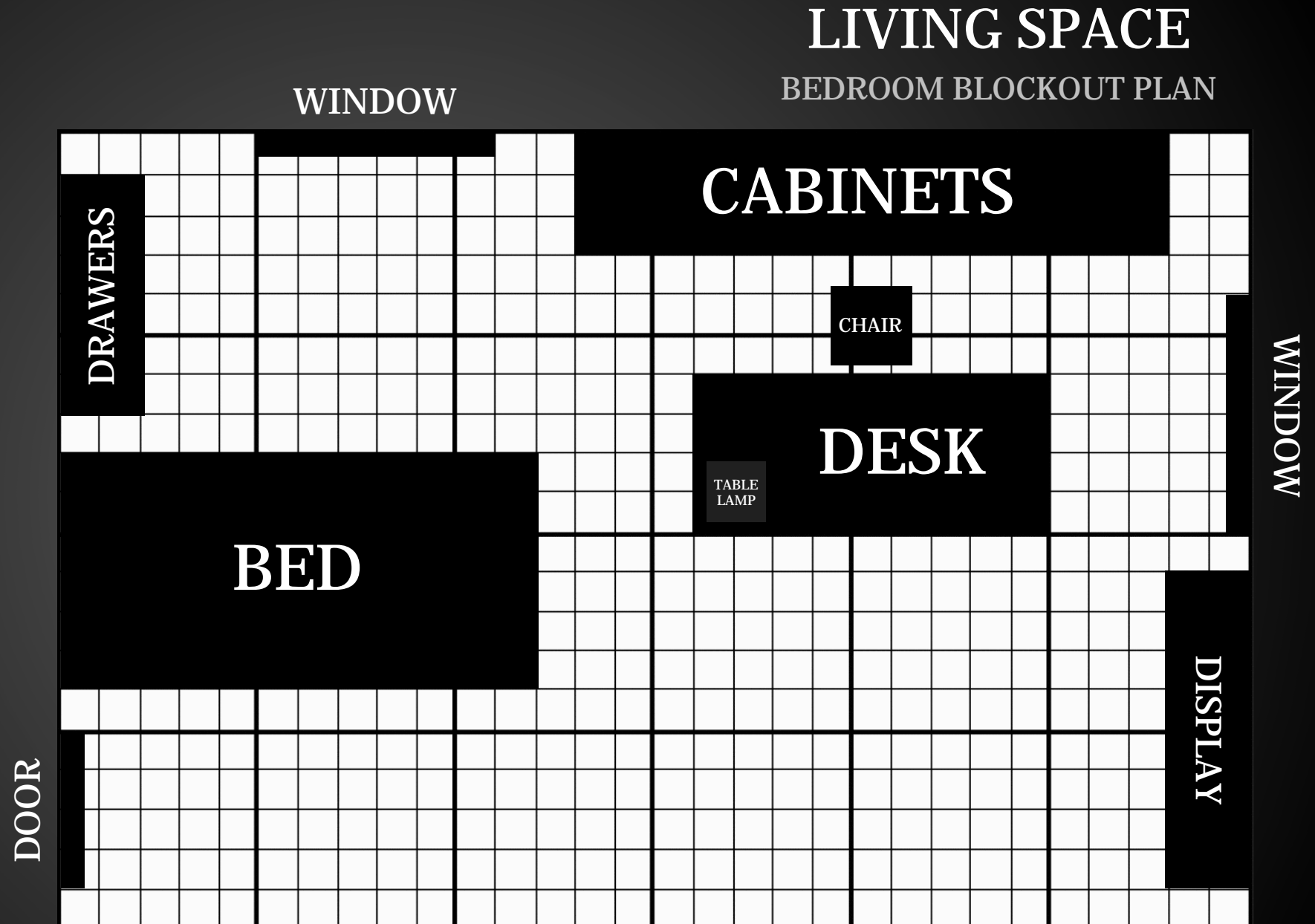

LIVING SPACE

REFERENCE IMAGES

Dutch photographer, Niki Feijen takes great pictures of abandoned and decayed buildings.



LIVING SPACE

REFERENCE IMAGES



© Niki Feijen

LIVING SPACE

REFERENCE IMAGES



© Niki Feijen

LIVING SPACE

REFERENCE IMAGES



© Niki Feijen

LIVING SPACE

REFERENCE IMAGES



© Niki Feijen

LIVING SPACE

REFERENCE IMAGES



© Niki Feijen

LIVING SPACE

REFERENCE IMAGES



© Niki Feijen